

# High Frequency Off Grid Solar Inverter

## PV1800 PRO Series (8-10KW)

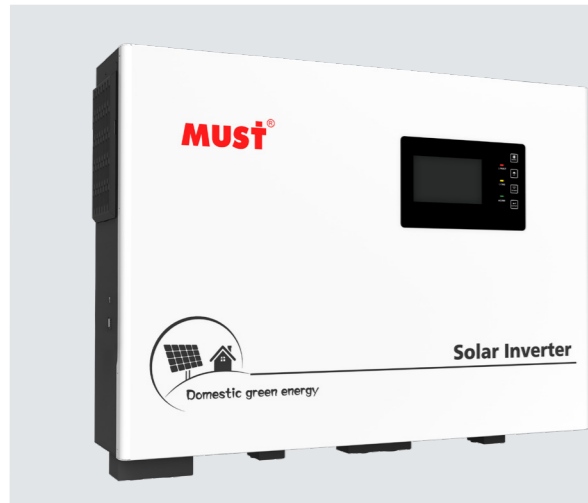

### Features

- Pure sine wave inverter
- Configurable input voltage range for home appliances and personal computers via LCD setting
- Configurable battery charging current based on applications via LCD setting
- Configurable AC/Solar Charger priority via LCD setting
- Compatible to mains voltage or generator power
- Auto restart while AC is recovering
- Overload/ Over temperature/ short circuit protection
- CAN/RS485 communication for BMS
- Cold start function
- WiFi remote monitoring (optional)

### Introduction

This is a multi-function inverter/charger, combining functions of inverter, solar charger and battery charger to offer uninterruptible power support with portable size. Its comprehensive LCD display offers user-configurable and easy-accessible button operation such as battery charging current, AC/solar charger priority, and acceptable input voltage based on different applications.

### Back panel printing description

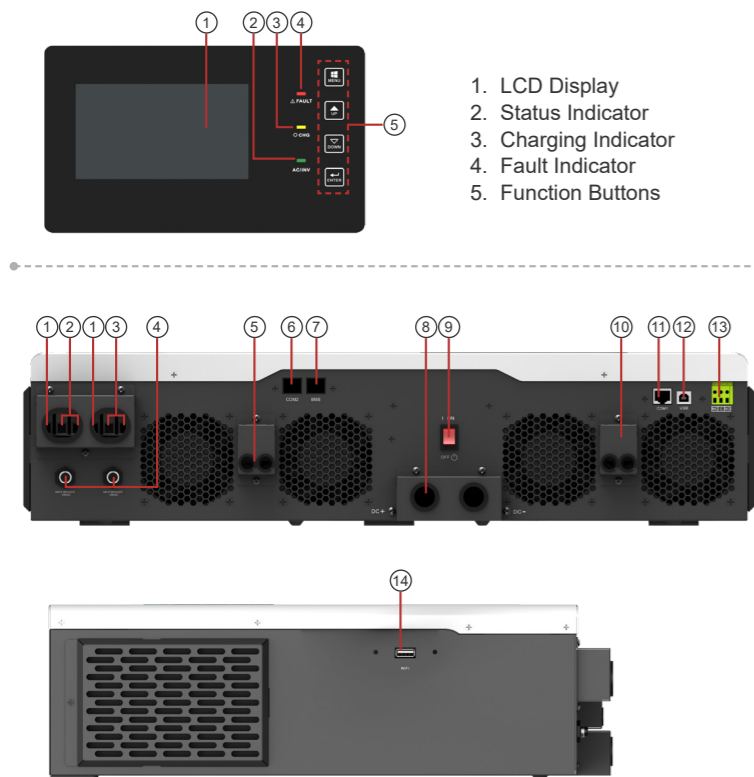

1. LCD Display
2. Status Indicator
3. Charging Indicator
4. Fault Indicator
5. Function Buttons

### Solar system connection

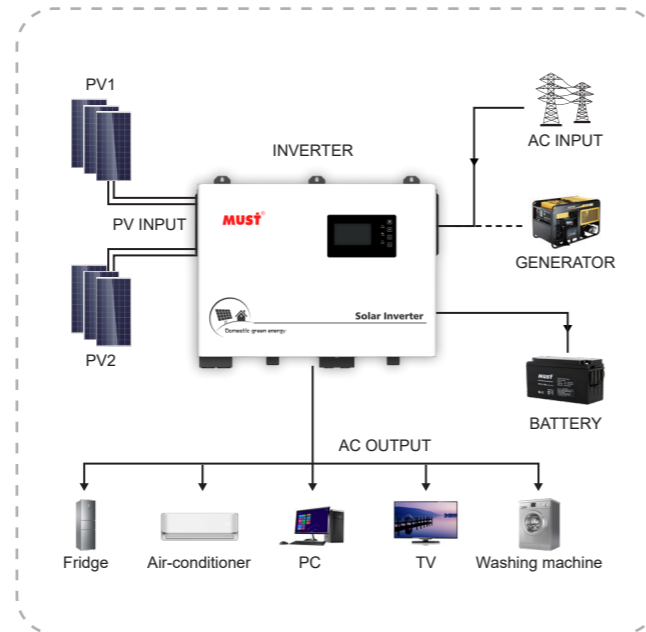

- |                     |                        |                |
|---------------------|------------------------|----------------|
| 1. Ground           | 6. COM2                | 11.COM1        |
| 2. AC Input         | 7. BMS communication   | 12.USB         |
| 3. AC Output        | 8. Battery input       | 13.Dry contact |
| 4. AC input breaker | 9. Power on/off switch | 14.WiFi port   |
| 5. PV input         | 10.PV input            |                |

### Specification

MODEL		PV18-8048 PRO	PV18-10048 PRO
Nominal Battery System Voltage		48VDC	
INVERTER OUTPUT	Rated Power	8000W	10000W
	Surge Power	16000W	20000W
	Waveform	Pure Sine Wave	
	AC Voltage Regulation (Batt.Mode)	230VAC±5%	
	Output Frequency	60Hz or 50Hz	
	Inverter Efficiency(Peak)	90%	
	Transfer Time	10ms (UPS) 20ms (APL)	
	AC INPUT	Nominal Input Voltage	230VAC
Max AC Input Voltage		300VAC	
Selectable Voltage Range		170~280VAC (UPS) / 90~280VAC (APL) / 184~253VAC(VDE4105)	
Frequency Range		50Hz / 60Hz(Auto detection)	
BATTERY	Normal Voltage	48VDC	
SOLAR CHARGER & AC CHARGER	AC Charging Current	2-120A	2-160A
	Maximum PV Array Open Circuit Voltage	450VDC	
	PV Array Open Circuit Voltage	150-430VDC	
	Cold Start Voltage	46VDC	
	Solar Charging Current	80A/80A	100A/100A
	Default Charging Current	80A/80A	
	Maximum Charge Current	160A	200A
	Charging Algorithm	3-step (Flooded Battery / AGM / GEL/ LEAD Battery), 4-step(LI)	
MECHANICAL SPECIFICATIONS	Machine Dimension (W*H*D)	600*503*141.2mm	
	Package Dimension (W*H*D)	/	
	G.W (kg)	21kg	
	N.W (kg)	/	
OTHER	Safety Certification	CE	
	Operating Temperature	-10°C~50°C	
	Storage Temperature	-15°C ~60°C	