

High Frequency On/Off Hybrid Solar Inverter

PH1800 PRO Series (8-10KW)

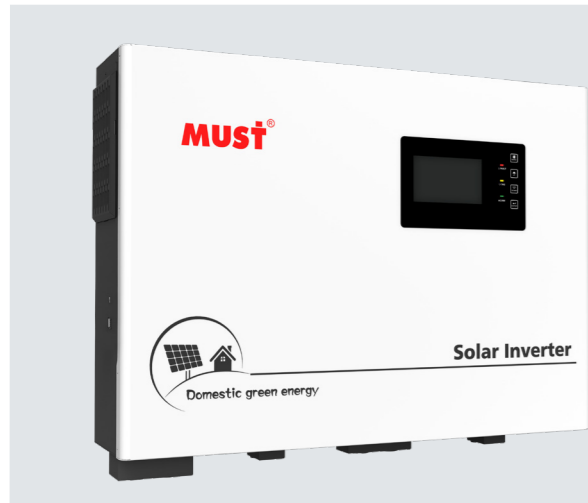

Features

- Pure sine wave inverter
- Configurable input voltage range for home appliances and personal computers via LCD setting
- Configurable battery charging current based on applications via LCD setting
- Configurable AC/Solar Charger priority via LCD setting
- Compatible to mains voltage or generator power
- Auto restart while AC is recovering
- Overload/ Over temperature/ short circuit protection
- CAN/RS485 communication for BMS
- Cold start function
- WiFi remote monitoring (optional)

Introduction

This is a multi-function inverter/charger, combining functions of inverter, solar charger and battery charger to offer uninterruptible power support with portable size. Its comprehensive LCD display offers user-configurable and easy-accessible button operation such as battery charging current, AC/solar charger priority, and acceptable input voltage based on different applications.

Back panel printing description

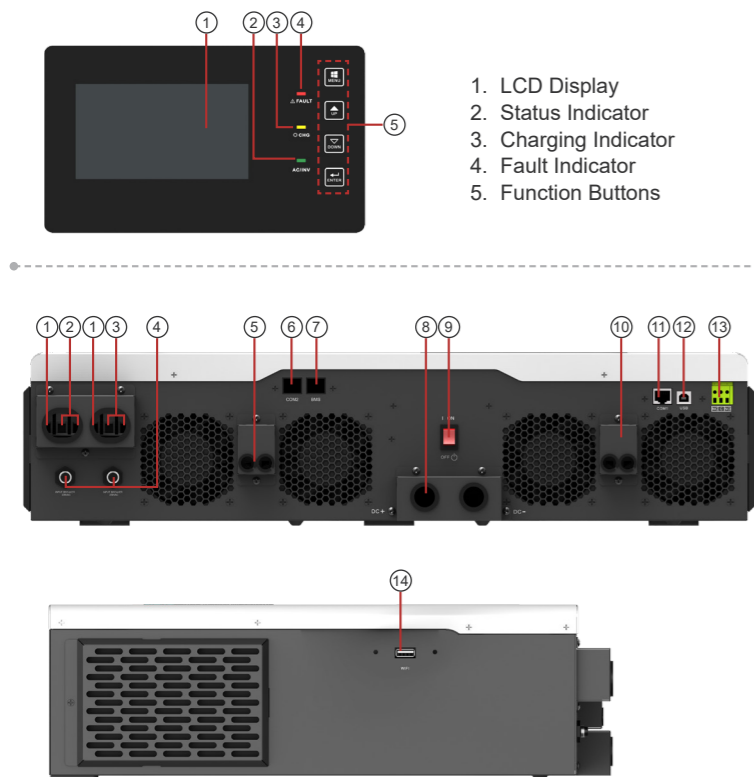

1. LCD Display
2. Status Indicator
3. Charging Indicator
4. Fault Indicator
5. Function Buttons

Solar system connection

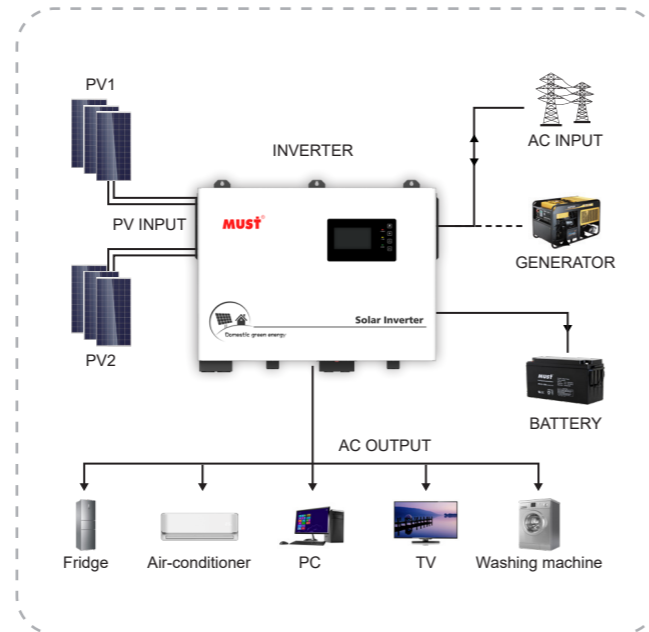

1. Ground
2. AC Input
3. AC Output
4. AC input breaker
5. PV input
6. COM2
7. BMS communication
8. Battery input
9. Power on/off switch
10. PV input
11. COM1
12. USB
13. Dry contact
14. WiFi port

Specification

MODEL		PH18-8048 PRO	PH18-10048 PRO
Nominal Battery System Voltage		48VDC	
INVERTER OUTPUT	Rated Power	8000W	10000W
	Surge Power	16000W	20000W
	Waveform	Pure Sine Wave	
	AC Voltage Regulation (Batt.Mode)	230VAC±5%	
	Output Frequency	60Hz or 50Hz	
	Inverter Efficiency(Peak)	90%	
	Transfer Time	10ms (UPS) 20ms (APL)	
	AC INPUT	Nominal Input Voltage	230VAC
Max AC Input Voltage		300VAC	
Selectable Voltage Range		170~280VAC (UPS) / 90~280VAC (APL) / 184~253VAC(VDE4105)	
Frequency Range		50Hz / 60Hz(Auto detection)	
BATTERY	Normal Voltage	48VDC	
SOLAR CHARGER & AC CHARGER	AC Charging Current	2-120A	2-160A
	Maximum PV Array Open Circuit Voltage	450VDC	
	PV Array Open Circuit Voltage	150-430VDC	
	Cold Start Voltage	46VDC	
	Solar Charging Current	80A/80A	100A/100A
	Default Charging Current	80A/80A	
	Maximum Charge Current	160A	200A
	Charging Algorithm	3-step (Flooded Battery / AGM / GEL/ LEAD Battery), 4-step(LI)	
MECHANICAL SPECIFICATIONS	Machine Dimension (W*H*D)	600*503*141.2mm	
	Package Dimension (W*H*D)	/	
	G.W (kg)	21kg	
	N.W (kg)	/	
OTHER	Safety Certification	CE	
	Operating Temperature	-10°C~50°C	
	Storage Temperature	-15°C ~60°C	